

Manual Push Quick-View Infusion Mat

Watch a how-to video at hizentra.ca, or refer to your Hizentra[®] Patient Resource binder for full administration instructions.

STEP

1

Get Ready

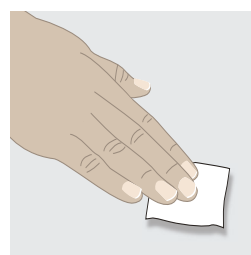

1 Clean surface.



2 Gather supplies.

3 Wash hands.

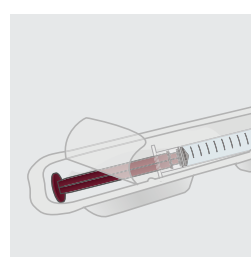

4 Check pre-filled syringes or vials.

If using pre-filled syringes:
Peel back the transparent covering from the tray. Inspect the protective cap.

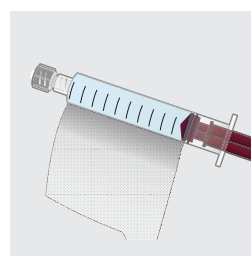

Peel back the outer layer of the label, but don't remove it.

OR



If using vials:
Inspect the protective cap.

Hizentra[®] is a pale yellow to light brown clear solution. Check for particles or colour changes.

Do not use if:

- ✗ Liquid looks cloudy, contains particles or has changed colour.
- ✗ Protective cap is missing or defective.
- ✗ Expiration date has passed.

STEP

2

Prepare for Infusion

Pre-filled syringes

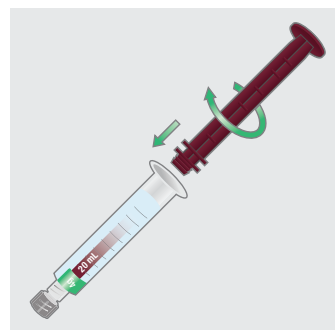

If you are using the 5 mL or 10 mL pre-filled syringe, go to **STEP 3**.

If you are using the 20 mL pre-filled syringe, screw the plunger rod onto the syringe stopper. Then, go to **STEP 3**.

Vials

1 Take off the protective cap.



2 Clean vial stopper with an antiseptic wipe.

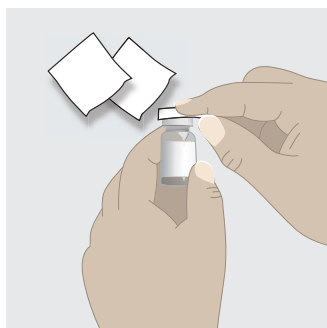

3 Transfer to syringe.

If using a **transfer device**, follow the manufacturer's instructions. Then, go to **STEP 3**.

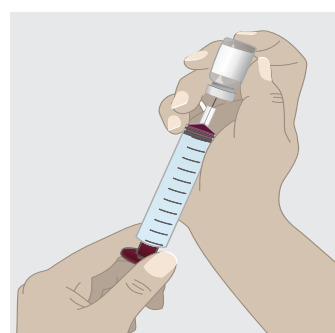
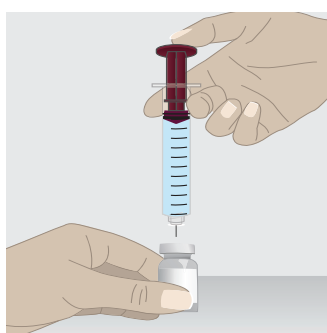
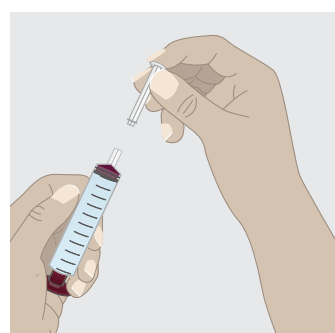

When using multiple vials to achieve the desired dose, repeat this step, then go to **STEP 3**.

STEP

3

Infuse

1 Prime tubing.

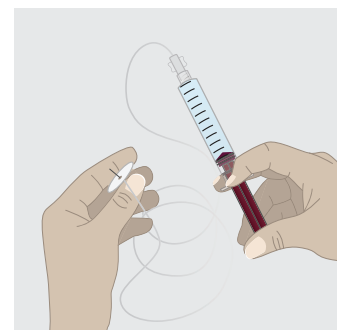

2 Prepare injection site(s).

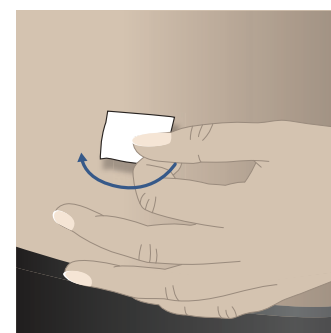
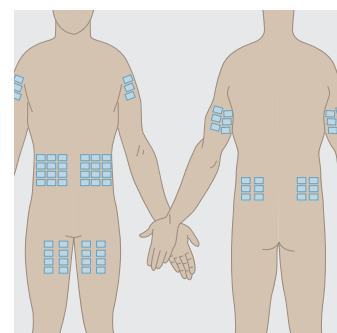

3 Insert needle(s).

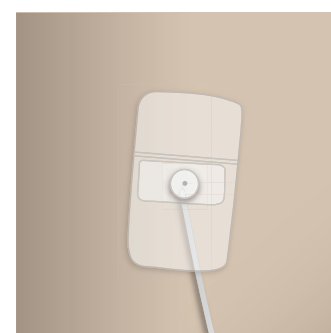
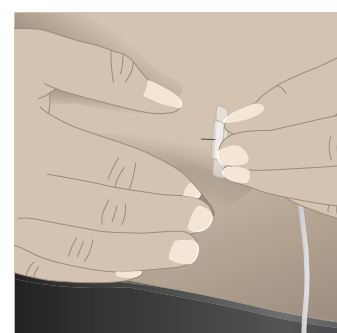

4 Start infusion.

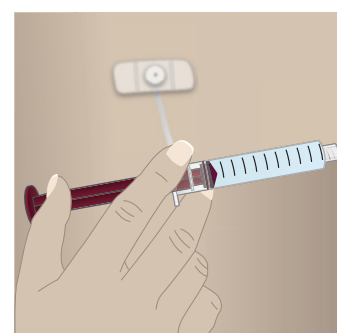

STEP

4

Record & Clean

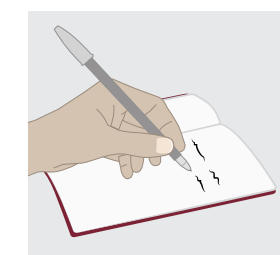

1 Record treatment.



2 Clean up.

Tell your healthcare provider about any problems you have during your infusions. Always follow the advice of your healthcare team.



Once you have received training from your healthcare provider to self-administer Hizentra[®], use this mat to help prepare for your infusion.

For more information, please consult the Consumer Information contained in your Hizentra[®] box or talk to your healthcare provider.



Infusion Pump Quick-View Infusion Mat

Watch a how-to video at hizentra.ca, or refer to your Hizentra® Patient Resource binder for full administration instructions.

STEP 1 1 Get Ready

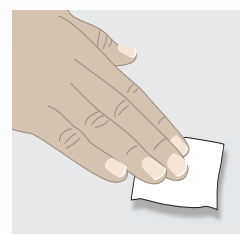

1 Clean surface.



2 Gather supplies.

3 Wash hands.

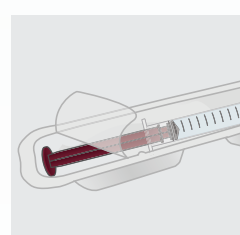

4 Check pre-filled syringes or vials.

If using pre-filled syringes:
Peel back the transparent covering from the tray. Inspect the protective cap.

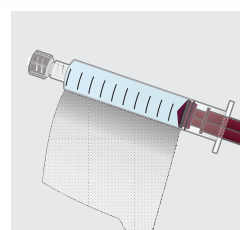

Peel back the outer layer of the label, but don't remove it.

OR



If using vials:
Inspect the protective cap.

Hizentra® is a pale yellow to light brown clear solution. Check for particles or colour changes.

Do not use if:

- ✗ Liquid looks cloudy, contains particles or has changed colour.
- ✗ Protective cap is missing or defective.
- ✗ Expiration date has passed.

STEP 2 2 Prepare for Infusion

Pre-filled syringes

If you are using the 5 mL or 10 mL pre-filled syringe, go to **STEP 3**.



If you are using the 20 mL pre-filled syringe, screw the plunger rod onto the syringe stopper before using.

If the Hizentra® pre-filled syringe size does not match the infusion pump requirements, transfer the contents of the pre-filled syringe to another syringe specific for your pump using the syringe-to-syringe transfer device.

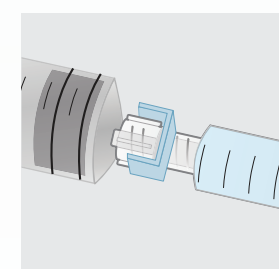
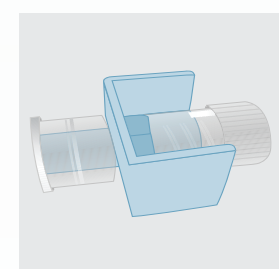

Vials

1 Take off the protective cap.

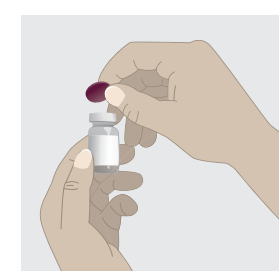

2 Clean vial stopper with an antiseptic wipe.

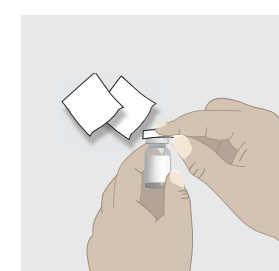

3 Transfer to syringe.

If using a **transfer device**, follow the manufacturer's instructions. Then, go to **STEP 3**.

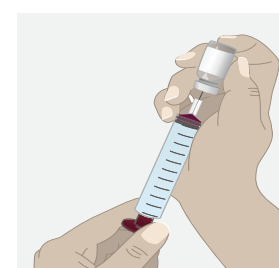
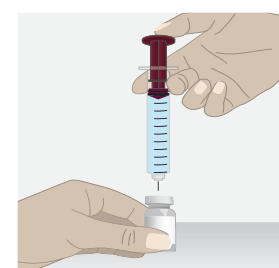
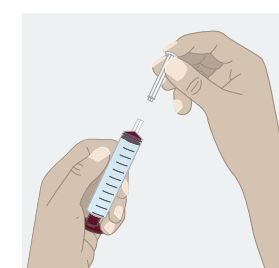

When using multiple vials to achieve the desired dose, repeat this step, then go to **STEP 3**.

STEP 3 3 Infuse

1 Prepare pump and prime tubing.

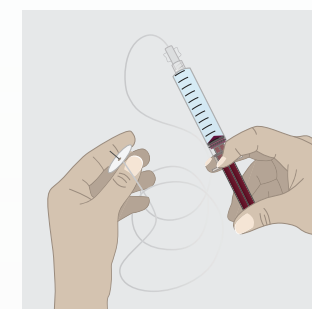

2 Prepare injection site(s).

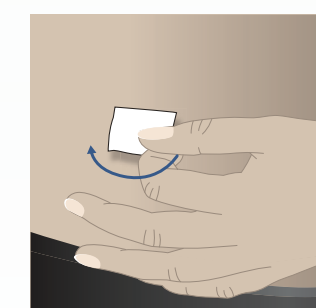
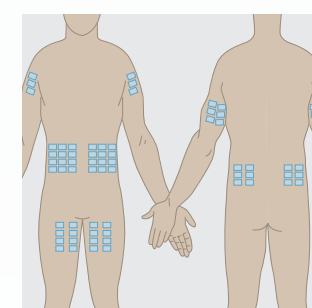

3 Insert needle(s).

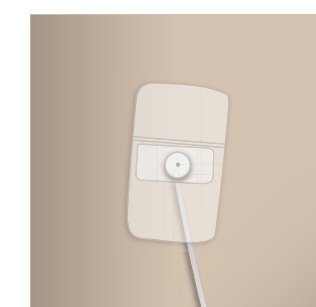
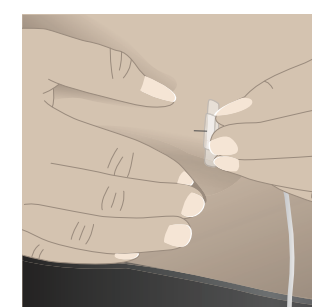

4 Start infusion.

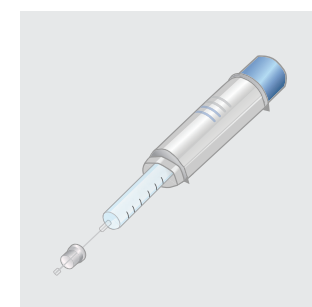

STEP 4 4 Record & Clean

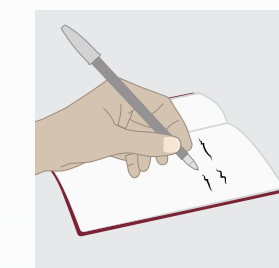

1 Record treatment.

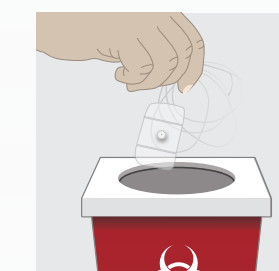

2 Clean up.

Tell your healthcare provider about any problems you have during your infusions. Always follow the advice of your healthcare team.



Once you have received training from your healthcare provider to self-administer Hizentra®, use this mat to help prepare for your infusion.

For more information, please consult the Consumer Information contained in your Hizentra® box or talk to your healthcare provider.